

**THE EAST RENFREWSHIRE COUNCIL**  
**(NETHERLEE & STAMPERLAND)**  
**(ON-STREET)(WAITING AND LOADING)**  
**ORDER 2016**

**THE EAST RENFREWSHIRE COUNCIL  
(NETHERLEE & STAMPERLAND) (ON-STREET) (WAITING AND LOADING) ORDER 2016**

<b><u>Contents</u></b>	<b><u>Page</u></b>
<b>Preamble and Definitions</b>	<b>1</b>
<b>Section 1 No Waiting and No Loading At Any Time</b>	<b>3</b>
<b>Section 2 No Waiting at Any Time</b>	<b>5</b>
<b>Section 3 No Waiting at Any Time and No Loading During Prescribed Hours</b>	<b>7</b>
<b>Section 4 Limited Waiting During Prescribed Hours</b>	<b>9</b>
<b>Section 5 No Waiting During Prescribed Hours</b>	<b>11</b>
<b>Section 6 Orders revoked</b>	<b>13</b>
<b>List of Schedules</b>	<b>14</b>
<b>Schedule 1 No Waiting and No Loading at Any Time</b>	<b>15</b>
<b>Schedule 2 No Waiting at Any Time</b>	<b>21</b>
<b>Schedule 3 No Waiting at Any Time and No Loading 8-9:30am and 4:30-6pm Monday to Saturday</b>	<b>29</b>
<b>Schedule 4 Waiting Limited to 60 Minutes with no return within 60 minutes 9:00am-5:00pm Monday-Friday</b>	<b>30</b>
<b>Schedule 5 No Waiting 8:00am-6:00pm Monday to Friday</b>	<b>31</b>
<b>Schedule 6 Orders to be revoked</b>	<b>32</b>

## **Preamble & Definitions**

The East Renfrewshire Council in exercise of the powers conferred on them by Sections 1(1), 2(1) to (3) Section 32 and Part IV of Schedule 9 of the Road Traffic Regulation Act 1984 ("the Act") and of all other enabling powers and after consultation with the Chief Constable of Police Scotland in accordance with Part III of Schedule 9 to the Act, hereby propose to make the following Order:-

1. This Order may be cited as "The East Renfrewshire Council (Netherlee & Stamperland) (On-Street) (Waiting and Loading) Order 2016" and shall come into operation on 4 November 2016.

2. In this order the following expressions have the meanings hereby assigned to them:-

"vehicle", unless the context otherwise requires, means a vehicle of any description and includes a machine or implement of any kind drawn or propelled along roads whether or not by mechanical power;

"taxi" has the same meaning as in Section 23(1) of the Civic Government (Scotland) Act 1982;

"disabled person's badge" has the same meaning as in the Local Authorities Traffic Orders (Exemptions for Disabled Persons) (Scotland) Regulations 2002;

"disabled person's vehicle" means a vehicle lawfully displaying a disabled person's badge in the relevant position;

"relevant position" has the same meaning as in Regulation 3 of the Local Authorities Traffic Orders (Exemptions for Disabled Person's) (Scotland) Regulations 2002;

"emergency service vehicle" means a vehicle being used by the police, fire brigade or ambulance services;

"local authority" means East Renfrewshire Council;

"Council" means the East Renfrewshire Council;

"parking bay" means a parking place which is provided for the leaving of a vehicle and is appropriately signed as per the Traffic Signs Regulations and General Directions 2016;

"parking attendant" has the same meaning as in Section 63A of the Road Traffic Regulation Act 1984

"universal postal service provider" has the same meaning as in Part 3 of the Postal Services Act 2011;

"universal postal service" shall be construed in accordance with Part 3 of the Postal Services Act 2011;

"load" means to wait for the purpose of placing or removing any object of any description into or from a vehicle;

"bus stop" means a bus service stopping place which is appropriately signed as per Traffic Signs Regulations and General Directions 2016;

“stopping place”-, in relation to a bus service, has the same meaning as in Part VI (Section 137 (1)) of the Transport Act of 1985;

“bus service” has the same meaning as in Schedule 1(1) of the Transport Act of 1985;

**Note:**

(i) All words importing the singular also include the plural and vice versa where the context requires.

(ii) Except where the context otherwise requires, references to any enactment include any such enactment as amended, extended or applied or re-enacted by or under any other enactment for the time being in force. Enactment means orders, rules, regulations, directions, bylaws and other instruments made or to be made, issued or given under any Act or deriving validity therefrom.

(iii) All signs, carriageway markings etc shall comply with the Traffic Signs Regulations and General Directions 2016.

**Section 1: No waiting and No Loading at any time**

**For the lengths of road listed in Schedule 1 there is no waiting and no loading at any time.**

1/01 Save as provided in Articles 1/02, of this Order no person shall, except upon the direction or with the permission of a police constable in uniform or a parking attendant in uniform cause or permit any vehicle to wait or load at any time in any of the lengths of road specified in Schedule 1 to this Order.

1/02 Nothing in Article 1/01 of this Order shall:

(a) prevent any person from causing or permitting a vehicle to wait or load in any of the lengths of road referred to in these Articles :-

- (i) for so long as may be necessary to enable a person together with his/her personal luggage to board or alight from the vehicle;
- (ii) for so long as may be necessary to enable the vehicle if it cannot be conveniently used for such purposes in any other road, to be used in connection with any building operation or demolition, the removal of any obstruction to traffic, the maintenance, improvement or reconstruction of any of the length of the road so referred to, or the laying, erection, alteration or repair in or near to any of the said length of the road, of any sewer or of any main, pipe or apparatus for the supply of gas, water or electricity, or of any telecommunications apparatus, as defined in the Telecommunications Act, 1984;
- (iii) to enable the vehicle, if it cannot conveniently be used for such purpose in any other road, to be used in pursuance of statutory powers and duties and in particular, but without prejudice to the generality of the foregoing, to enable the vehicle to be used in connection with police, fire brigade and ambulance purposes;
- (iv) if the vehicle is waiting owing to the driver being prevented from proceeding by circumstances beyond his/her control or to such waiting being necessary in order to avoid an accident;
- (v) If the vehicle bearing the livery of a universal postal service provider is in the service of or employed by a universal postal service provider in the course of the provision of a universal postal service and is stationary only for so long as may be reasonably necessary for postal packets to be collected or delivered to or from adjacent premises or posting boxes;
- (vi) for the purpose of loading or unloading the vehicle while the vehicle is standing at the kerb and is in actual use in connection with the removal of furniture from one office or dwelling house to another or the removal of furniture from such premises to a depository or to such premises from a depository;

(vii) to enable the vehicle to be used wholly and necessarily by the principal participants in connection with funeral operations and weddings.

(b) apply to an emergency service vehicle.

(c) apply to a bus stop.

## **Section 2: No Waiting at Any Time**

### **For the lengths of road listed in Schedule 2 there is no waiting at any time.**

2/01 Save as provided in Articles 2/02, 2/03 and 2/04 of this Order no person shall, except upon the direction or with the permission of a police constable in uniform or a parking attendant in uniform, cause or permit any vehicle to wait at the times prescribed in any of the lengths of road specified in Schedule 2 to this Order.

2/02 Nothing in Article 2/01 of this Order shall:

- (a) prevent any person from causing or permitting a vehicle to wait in any of the lengths of road referred to in these Articles :-
  - (i) for so long as may be necessary to enable a person together with his/her personal luggage to board or alight from the vehicle;
  - (ii) for so long as may be necessary to enable the vehicle if it cannot be conveniently used for such purposes in any other road, to be used in connection with any building operation or demolition, the removal of any obstruction to traffic, the maintenance, improvement or reconstruction of any of the length of the road so referred to, or the laying, erection, alteration or repair in or near to any of the said length of the road, of any sewer or of any main, pipe or apparatus for the supply of gas, water or electricity, or of any telecommunications apparatus, as defined in the Telecommunications Act, 1984;
  - (iii) to enable the vehicle, if it cannot conveniently be used for such purpose in any other road, to be used in pursuance of statutory powers and duties and in particular, but without prejudice to the generality of the foregoing, to enable the vehicle to be used in connection with police, fire brigade and ambulance purposes;
  - (iv) if the vehicle is waiting owing to the driver being prevented from proceeding by circumstances beyond his/her control or to such waiting being necessary in order to avoid an accident;
  - (v) If the vehicle bearing the livery of a universal service provider is in the service of or employed by a universal service provider in the course of the provision of a universal postal service and is stationary only for so long as may be reasonably necessary for postal packets to be collected or delivered to or from adjacent premises or posting boxes;
  - (vi) for the purpose of loading or unloading the vehicle while the vehicle is standing at the kerb and is in actual use in connection with the removal of furniture from one office or dwelling house to another or the removal of furniture from such premises to a depository or to such premises from a depository;

(vii) to enable the vehicle to be used wholly and necessarily by the principal participants in connection with funeral operations and weddings.

(b) apply to a licensed taxi waiting in a taxi stance during any period for which that stance has been appointed as a taxi stance by the licensing authority under the Civic Government (Scotland) Act 1982.

(c) apply to an emergency service vehicle.

(d) apply to a bus stop.

2/03 Nothing in Article 2/01 of this Order shall apply to any disabled person's vehicle which is not causing an obstruction and which displays in the relevant position a disabled person's badge.

2/04 (a) Nothing in Article 2/01 of this Order shall prevent any person from causing or permitting a vehicle to wait in the roads specified for as long as may be necessary for the purpose of delivering or collecting goods or merchandise or loading or unloading the vehicle at premises adjoining that road provided that:

(i) no vehicle shall wait for longer than a period of 10 minutes in the same place without goods being physically loaded onto or unloaded from the vehicle; and

(ii) no vehicle engaged in delivering or collecting goods or merchandise or loading or unloading shall wait for a longer period than thirty minutes in the same place;

(b) Notwithstanding anything in paragraph (a) of this Article the driver of a vehicle waiting for the purpose of delivering or collecting goods or merchandise or loading or unloading the vehicle shall move the same on the instruction of a police constable in uniform or a parking attendant in uniform whenever such moving may be reasonably necessary for the purpose of preventing an obstruction.



**Section 3 No Waiting at Any Time and No Loading During Prescribed Hours**

**For the lengths of road listed in Schedule 3 to this Order, the times prescribed for Section 3 are: No Waiting at Any Time and No Loading 8:00am-9:30am and 4:30pm-6:00pm Monday to Saturday**

3/01 Save as provided in Articles 3/02, 3/03 and 3/04 of this Order no person shall, except upon the direction or with the permission of a police constable in uniform or a parking attendant in uniform cause or permit any vehicle to wait or load at the times prescribed on any of the lengths of road specified in Schedule 3 to this Order. The prescribed times for Section 3 are:

For the lengths of road listed in Schedule 3- no waiting at any time and no loading 8am-9:30am and 4:30pm-6pm Monday to Saturday

3/02 Nothing in Article 3/01 of this Order shall:

(a) prevent any person from causing or permitting a vehicle to wait in any of the lengths of road referred to in these Articles :-

(i) for so long as may be necessary to enable a person together with his/her personal luggage to board or alight from the vehicle;

(ii) for so long as may be necessary to enable the vehicle if it cannot be conveniently used for such purposes in any other road, to be used in connection with any building operation or demolition, the removal of any obstruction to traffic, the maintenance, improvement or reconstruction of any of the length of the road so referred to, or the laying, erection, alteration or repair in or near to any of the said length of the road, of any sewer or of any main, pipe or apparatus for the supply of gas, water or electricity, or of any telecommunications apparatus, as defined in the Telecommunications Act, 1984;

(iii) to enable the vehicle, if it cannot conveniently be used for such purpose in any other road, to be used in pursuance of statutory powers and duties and in particular, but without prejudice to the generality of the foregoing, to enable the vehicle to be used in connection with police, fire brigade and ambulance purposes;

(iv) if the vehicle is waiting owing to the driver being prevented from proceeding by circumstances beyond his/her control or to such waiting being necessary in order to avoid an accident;

(v) If the vehicle bearing the livery of a universal postal service provider is in the service of or employed by a universal postal service provider in the course of the provision of a universal postal service and is stationary only for so long as may be reasonably necessary for postal packets to be collected or delivered to or from adjacent premises or posting boxes;

(vi) for the purpose of loading or unloading the vehicle while the vehicle is standing at the kerb and is in actual use in connection with the removal of

furniture from one office or dwelling house to another or the removal of furniture from such premises to a depository or to such premises from a depository;

(vii) to enable the vehicle to be used wholly and necessarily by the principal participants in connection with funeral operations and weddings.

(b) apply to a licenced taxi waiting in a taxi stance during any period for which that stance has been appointed as a taxi stance by the licensing authority under the Civic Government (Scotland) Act 1982.

(c) apply to an emergency service vehicle.

(d) apply to a bus stop.

**Section 4: Limited Waiting During Prescribed Hours**

**For the lengths of road listed in Schedule 4 to this Order the times prescribed are: Waiting limited to 60 minutes with no return within 60 minutes 9:00am-5:00pm Monday to Friday**

4/01 Save as provided in Articles 4/02, 4/03 and 4/04 of this Order no person shall, except upon the direction or with the permission of a police constable in uniform or a parking attendant in uniform, cause or permit any vehicle to wait between the hours of 9:00am-5:00pm Monday to Friday inclusive in any of the lengths of road specified in Schedule 4 to this Order:

- a) for a period longer than 60 minutes ; or
- b) if a period of less than 60 minutes has elapsed since the last period or waiting of the vehicle in any of the said lengths of roads.

4/02 Nothing in Article 4/01 of this Order shall:

- (a) prevent any person from causing or permitting a vehicle to wait in any of the lengths of road referred to in these Articles :-
  - (i) for so long as may be necessary to enable a person to board or alight from the vehicle or to load thereon or unload therefrom his/her personal luggage;
  - (ii) for so long as may be necessary to enable the vehicle if it cannot be conveniently used for such purposes in any other road, to be used in connection with any building operation or demolition, the removal of any obstruction to traffic, the maintenance, improvement or reconstruction of any of the length of the road so referred to, or the laying, erection, alteration or repair in or near to any of the said length of the road, of any sewer or of any main, pipe or apparatus for the supply of gas, water or electricity, or of any telecommunications apparatus, as defined in the Telecommunications Act, 1984;
  - (iii) to enable the vehicle, if it cannot conveniently be used for such purpose in any other road, to be used in pursuance of statutory powers and duties and in particular, but without prejudice to the generality of the foregoing, to enable the vehicle to be used in connection with police, fire brigade and ambulance purposes;
  - (iv) if the vehicle is waiting owing to the driver being prevented from proceeding by circumstances beyond his/her control or to such waiting being necessary in order to avoid an accident;
  - (v) If the vehicle bearing the livery of a universal service provider is in the service of or employed by a universal service provider in the course of the provision of a universal postal service and is stationary only for so long as may be reasonably necessary for postal packets to be collected or delivered to or from adjacent premises or posting boxes;

(vi) for the purpose of loading or unloading the vehicle while the vehicle is standing at the kerb and is in actual use in connection with the removal of furniture from one office or dwelling house to another or the removal of furniture from such premises to a depository or to such premises from a depository;

(vii) to enable the vehicle to be used wholly and necessarily by the principal participants in connection with funeral operations and weddings.

(b) apply to a licensed taxi waiting in a taxi stance during any period for which that stance has been appointed as a taxi stance by the licensing authority under the Civic Government (Scotland) Act 1982.

(c) apply to an emergency service vehicle.

(d) apply to a bus stop.

4/03 Nothing in Article 4/01 of this Order shall apply to any disabled person's vehicle which is not causing an obstruction and which displays in the relevant position a disabled person's badge.

4/04 Nothing in Articles 4/01 to 4/02 of this Order shall prevent any person from causing or permitting a vehicle to wait in the roads specified :

(a) for as long as may be necessary for the purpose of delivering or collecting goods or merchandise or loading or unloading the vehicle at premises adjoining that road provided that no vehicle engaged in delivering or collecting goods or merchandise or being loaded or unloaded shall wait:

(i) no vehicle shall wait for longer than a period of 10 minutes in the same place without goods being physically loaded onto or unloaded from the vehicle;

(ii) for a longer period than thirty minutes in the same place; and

(b) notwithstanding anything in paragraph (a) of this Article the driver of a vehicle waiting for the purpose of delivering or collecting goods or merchandise or loading or unloading the vehicle shall move the same on the instruction of a police constable in uniform or a parking attendant in uniform whenever such moving may be reasonably necessary for the purpose of preventing an obstruction.

**Section 5: No waiting during prescribed hours**

**For the lengths of road listed in Schedule 5 to this Order, the times prescribed are: No Waiting 8am – 6pm Monday to Friday**

5/01 Save as provided in Articles 5/02, 5/03 and 5/04 of this Order no person shall, except upon the direction or with the permission of a police constable in uniform or a parking attendant in uniform, cause or permit any vehicle to wait at the times prescribed on any of the lengths of road specified in Schedules 5 to this Order. The prescribed times for Section 5 are:

For the lengths of road listed in Schedule 5 to this Order, the times prescribed are: No Waiting 8am – 6pm Monday to Friday inclusive;

5/02 Nothing in Article 5/01 of this Order shall:

(a) prevent any person from causing or permitting a vehicle to wait in any of the lengths of road referred to in these Articles :-

- (i) for so long as may be necessary to enable a person together with his/her personal luggage to board or alight from the vehicle;
- (ii) for so long as may be necessary to enable the vehicle if it cannot be conveniently used for such purposes in any other road, to be used in connection with any building operation or demolition, the removal of any obstruction to traffic, the maintenance, improvement or reconstruction of any of the length of the road so referred to, or the laying, erection, alteration or repair in or near to any of the said length of the road, of any sewer or of any main, pipe or apparatus for the supply of gas, water or electricity, or of any telecommunications apparatus, as defined in the Telecommunications Act, 1984;
- (iii) to enable the vehicle, if it cannot conveniently be used for such purpose in any other road, to be used in pursuance of statutory powers and duties and in particular, but without prejudice to the generality of the foregoing, to enable the vehicle to be used in connection with police, fire brigade and ambulance purposes;
- (iv) if the vehicle is waiting owing to the driver being prevented from proceeding by circumstances beyond his/her control or to such waiting being necessary in order to avoid an accident;
- (v) If the vehicle bearing the livery of a universal service provider is in the service of or employed by a universal service provider in the course of the provision of a universal postal service and is stationary only for so long as may be reasonably necessary for postal packets to be collected or delivered to or from adjacent premises or posting boxes;
- (vi) for the purpose of loading or unloading the vehicle while the vehicle is standing at the kerb and is in actual use in connection with the removal of furniture from one office or dwelling house to another or the removal of

furniture from such premises to a depository or to such premises from a depository;

(vii) to enable the vehicle to be used wholly and necessarily by the principal participants in connection with funeral operations and weddings.

(b) apply to an emergency service vehicle.

(c) apply to a bus stop.

5/03 Nothing in Article 5/01 of this Order shall apply to any disabled person's vehicle which is not causing an obstruction and which displays in the relevant position a valid disabled person's badge.

5/04 (a) Nothing in Article 5/01 of this Order shall prevent any person from causing or permitting a vehicle to wait in the roads specified for as long as may be necessary for the purpose of delivering or collecting goods or merchandise or loading or unloading the vehicle at premises adjoining that road provided that:

(i) no vehicle shall wait for longer than a period of 10 minutes in the same place without goods being physically loaded onto or unloaded from the vehicle; and

(ii) no vehicle engaged in delivering or collecting goods or merchandise or loading or unloading shall wait for a longer period than 30 minutes in the same place;

(b) notwithstanding anything in paragraph (a) of this Article the driver of a vehicle waiting for the purpose of delivering or collecting goods or merchandise or loading or unloading the vehicle shall move the same on the instruction of a police constable in uniform or a parking attendant in uniform whenever such moving may be reasonably necessary for the purpose of preventing an obstruction.

**Section 6 Orders Revoked**

6/01 Those Orders specified in Schedule 6 to this Order are hereby revoked.

Given under the seal of The East Renfrewshire Council and signed for them and on their behalf by Joseph George Abrami, Principal Solicitor and duly Authorised Signatory together at Giffnock on the Twenty-first Day of September, Two Thousand and Sixteen.

A handwritten signature in blue ink, appearing to read 'J. Abrami', is written in a cursive style.

## List of Schedules

### Schedule 1

No waiting at any time &  
No loading at any time

### Schedule 2

No waiting at any time

### Schedule 3

No waiting at any time &  
No loading 8:00am-9:30am & 4:30pm-6:00pm Monday to Saturday

### Schedule 4

Waiting limited to 60 minutes 9:00am-5:00pm Monday-Friday No return within 60 minutes

### Schedule 5

No waiting 8:00am – 6:00pm Monday-Friday

### Schedule 6

Orders to be revoked



**SCHEDULE 1**  
**NO WAITING AND NO LOADING AT ANY TIME**

**Roads In East Renfrewshire**

**Side of road to  
which  
restriction  
applies**

**Ref**    **Principal  
Reference Road**    **Secondary  
Reference**

**Lengths of road in East Renfrewshire**

<b>1</b>	<b>Beechlands Avenue</b>			
1/1		Clarkston Road	From the extended western kerbline of Clarkston Road westwards for a distance of 15 metres or thereby.	Both
<b>2</b>	<b>Brenfield Road</b>			
2/1		Clarkston Road	From the extended eastern kerbline of Clarkston Road eastwards for a distance of 15 metres or thereby.	South
<b>3</b>	<b>Bute Gardens</b>			
3/1		Clarkston Road	From the eastern kerbline of Clarkston Road eastwards for a distance of 15 metres or thereby.	Both
<b>4</b>	<b>Clarkston Road</b>			
4/1		Beechlands Avenue	From a point 10 metres or thereby north of the extended northern kerbline of Beechlands Avenue southwards to a point 10 metres or thereby south of the extended southern kerbline of Beechlands Avenue.	West
4/2		Brenfield Road	From the extended southern kerbline of Brenfield Road southwards to a point 10 metres or thereby south of the extended southern kerbline of Brenfield Road.	East
4/3		Bute Gardens	From a point 11 metres or thereby north of the extended northern kerbline of Bute Gardens southwards to a point 10 metres or thereby south of the extended southern kerbline of Bute Gardens.	East
4/4		Corrie Grove	From a point 12 metres or thereby north of the extended northern kerbline of Corrie Grove southwards to a point 14 metres or thereby south of the extended southern kerbline of Corrie Grove.	East

**SCHEDULE 1**  
**NO WAITING AND NO LOADING AT ANY TIME**

**Roads In East Renfrewshire**

Ref	Principal Reference Road	Secondary Reference	Lengths of road in East Renfrewshire	Side of road to which restriction applies
4/5		Deanwood Road	From a point 15 metres or thereby north of the extended northern kerbline of Deanwood Road southwards to a point 15 metres or thereby south of the extended southern kerbline of Deanwood Road.	West
4/6		Feu line of 548 & 550	From the extended feu line between 548 and 550 Clarkston Road south-eastwards and then south-westwards to a point 2 metres or thereby south of the extended northern feu line of 558 Clarkston Road.	West
4/7		Feu line of 657 & 659	From the extended feu line between 657 and 659 Clarkston Road south-eastwards and then south-westwards to a point 10 metres or thereby southwest of the extended southern kerbline of Linnpark Avenue.	East
4/8		First Avenue	From a point 20 metres or thereby north-east of the extended northern kerbline of First Avenue south-westwards to a point 15 metres or thereby southwest of the extended southern kerbline of First Avenue.	East
4/9		Linn Drive	From a point 15 metres or thereby north of the extended northern kerbline of Linn Drive southwards to a point 15 metres or thereby south of the extended southern kerbline of Linn Drive.	East
4/10		Muirend Road	From the extended southern kerbline of Muirend Road southwards for a distance of 37 metres or thereby.	West
4/11		Netherburn Avenue	From a point 15 metres or thereby northeast of the extended northern kerbline of Netherburn Avenue south-eastwards to a point 10 metres or thereby southwest of the extended southern kerbline of Netherburn Avenue.	East
4/12		Nethercliffe Avenue	From a point 25 metres or thereby northeast of the extended northern kerbline of Strathview Park southwards to a point 19 metres or thereby south of the	East

**SCHEDULE 1**  
**NO WAITING AND NO LOADING AT ANY TIME**

Roads In East Renfrewshire			Lengths of road in East Renfrewshire	Side of road to which restriction applies
Ref	Principal Reference Road	Secondary Reference		
			extended southern kerbline of Nethercliffe Avenue.	
4/13		Nethervale Avenue	From a point 15 metres or thereby north of the extended northern kerbline of Nethervale Avenue southwards to a point 10 metres or thereby south of the extended southern kerbline of Nethervale Avenue.	East
4/14		Ormonde Drive	From a point 15 metres or thereby northeast of the extended northern kerbline of Ormonde Avenue south-westwards to a point 12 metres or thereby southwest of the extended southern kerbline of Ormonde Drive.	West
4/15		Parklands Road	From a point 15 metres or thereby northwest of the extended northern kerbline of Parklands Road south-eastwards to a point 15 metres or thereby southeast of the extended southern kerbline of Parklands Road.	West
4/16		Randolph Drive	From a point 10 metres or thereby north of the extended northern kerbline of Randolph Drive southwards to a point 10 metres or thereby south of the extended southern kerbline of Randolph Drive.	East
4/17		Stamperland Gardens	From a point 18 metres or thereby north of the extended northern kerbline of Stamperland Gardens southwards to a point 11 metres or thereby south of the extended southern kerbline of Stamperland Gardens.	East
4/18		Strathview Park	From a point 25 metres or thereby northeast of the extended northern kerbline of Strathview Park south-westwards and then southwards to the extended northern kerbline of Nethercliffe Avenue.	West
4/19		Williamwood Drive	From a point 10 metres or thereby northeast of the extended northern kerbline of Williamwood Drive south-westwards to a point 17 metres or thereby southwest of the extended southern kerbline of Williamwood Drive.	West

**SCHEDULE 1**  
**NO WAITING AND NO LOADING AT ANY TIME**

**Roads In East Renfrewshire**

**Ref**    **Principal Reference Road**    **Secondary Reference**

**Lengths of road in East Renfrewshire**

**Side of road to which restriction applies**

<b>5</b>	<b>Corrie Grove</b>			
5/1		Clarkston Road	From the extended eastern kerbline of Clarkston Road eastwards for a distance of 15 metres or thereby.	Both
<b>6</b>	<b>Deanwood Road</b>			
6/1		Clarkston Road	From the extended western kerbline of Clarkston Road westwards for a distance of 20 metres or thereby.	Both
<b>7</b>	<b>First Avenue</b>			
7/1		Clarkston Road	From the extended eastern kerbline of Clarkston Road eastwards for a distance of 20 metres or thereby.	Both
<b>8</b>	<b>Linn Drive</b>			
8/1		Clarkston Road	From the extended eastern kerbline of Clarkston Road eastwards for a distance of 15 metres or thereby.	Both
<b>9</b>	<b>Linnpark Avenue</b>			
9/1		Clarkston Road	From the extended eastern kerbline of Clarkston Road south-eastwards and then eastwards for a distance of 177 metres or thereby.	Both
<b>10</b>	<b>Muirend Road</b>			
10/1		Clarkston Road	From the extended western kerbline of Clarkston Road north-westwards to the extended eastern feu line of 9 Muirend Road.	South
<b>11</b>	<b>Netherburn Avenue</b>			
11/1		Clarkston Road	From the extended eastern kerbline of Clarkston Road eastwards for a distance of 10 metres or thereby.	North

**SCHEDULE 1**  
**NO WAITING AND NO LOADING AT ANY TIME**

**Roads In East Renfrewshire**

Ref	Principal Reference Road	Secondary Reference	Lengths of road in East Renfrewshire	Side of road to which restriction applies
11/2		Clarkston Road	From the extended eastern kerbline of Clarkston Road eastwards for a distance of 17 metres or thereby.	South
<b>12</b>	<b>Nethercliffe Avenue</b>			
12/1		Clarkston Road	From the extended eastern kerbline of Clarkston Road eastwards for a distance of 10 metres or thereby.	Both
<b>13</b>	<b>Netherlee Road</b>			
13/1		Clarkston Road	From the extended north-eastern kerbline of Clarkston Road northwards for a distance of 20 metres or thereby.	West
13/2		Clarkston Road	From the extended eastern kerbline of Clarkston Road northwards for a distance of 26 metres or thereby.	East
<b>14</b>	<b>Nethervale Avenue</b>			
14/1		Clarkston Road	From the extended eastern kerbline of Clarkston Road eastwards for a distance of 10 metres or thereby.	Both
<b>15</b>	<b>Ormonde Drive</b>			
15/1		Clarkston Road	From the extended western kerbline of Clarkston Road north-westwards for a distance of 15 metres or thereby.	Both
<b>16</b>	<b>Parklands Road</b>			
16/1		Clarkston Road	From the extended western kerbline of Clarkston Road south-westwards for a distance of 15 metres or thereby.	Both

**SCHEDULE 1**  
**NO WAITING AND NO LOADING AT ANY TIME**

**Roads In East Renfrewshire**

**Ref**    **Principal**    **Secondary**  
          **Reference Road**    **Reference**

**Lengths of road in East Renfrewshire**

**Side of road to**  
**which**  
**restriction**  
**applies**

<b>Ref</b>	<b>Principal Reference Road</b>	<b>Secondary Reference</b>	<b>Lengths of road in East Renfrewshire</b>	<b>Side of road to which restriction applies</b>
<b>17</b>	<b>Randolph Drive</b>			
17/1		Clarkston Road	From the extended eastern kerbline of Clarkston Road eastwards for a distance of 20 metres or thereby.	Both
<b>18</b>	<b>Stamperland Gardens</b>			
18/1		Clarkston Road	From the extended eastern kerbline of Clarkston Road south-eastwards for a distance of 10 metres or thereby.	Both
<b>19</b>	<b>Strathview Park</b>			
19/1		Clarkston Road	From the extended western kerbline of Clarkston Road north-westwards for a distance of 20 metres or thereby.	Both
<b>20</b>	<b>Williamwood Drive</b>			
20/1		Clarkston Road	From the extended western kerbline of Clarkston Road westwards for a distance of 20 metres or thereby.	Both
<b>21</b>	<b>Windlaw Gardens</b>			
21/2		Muirend Road	From the extended southern kerbline of Muirend Road southwards a distance of 10 metres or thereby.	Both



**SCHEDULE 2**  
**NO WAITING AT ANY**

**Roads In East Renfrewshire**

Ref	Principal Reference Road	Secondary Reference	Lengths of road in East Renfrewshire	Side of road to which restriction applies
<b>1</b>	<b>Hazelden Gardens</b>			
1/1		Hazelden Park	From the extended north-eastern feu line of 14 Hazelden Gardens westwards a distance of 28 metres or thereby.	North
1/2		Muirend Road	From the extended south-western kerbline of Muirend Road south-westwards and then westwards to the extended eastern building line of 14 Hazelden Gardens.	South & East
<b>2</b>	<b>Clarkston Road</b>			
2/1		Williamwood Drive	From the extended northern kerbline of Williamwood Drive northwards for a distance of 18 metres or thereby.	East
<b>3</b>	<b>Deanwood Road</b>			
3/1		Ormonde Avenue	From a point 10 metres or thereby east of the extended eastern kerbline of Ormonde Avenue westwards to a point 10 metres or thereby westwards of the extended western kerbline of Ormonde Avenue.	Both
<b>4</b>	<b>Elgin Gardens</b>			
4/1		Stamperland Gardens	From the extended western kerbline of Stamperland Gardens westwards for a distance of 8 metres or thereby.	Both
<b>5</b>	<b>First Avenue</b>			
5/1		1 First Avenue	From a point 2 metres or thereby east of the extended western feu line of 1 First Avenue westwards for a distance of 10 metres or thereby.	North
5/2		2 First Avenue	From a point 2 metres or thereby east of the extended western feu line of 2 First Avenue westwards for a distance of 10 metres or thereby.	South
5/3		39 First Avenue	From a point 2 metres or thereby west of the extended eastern feu line of 39 First Avenue eastwards for a distance of 10 metres or thereby.	North

**SCHEDULE 2**  
**NO WAITING AT ANY**

Roads In East Renfrewshire			Lengths of road in East Renfrewshire	Side of road to which restriction applies
Ref	Principal Reference Road	Secondary Reference		
5/4		44 First Avenue	From a point 2 metres or thereby west of the extended eastern feu line of 44 First Avenue eastwards for a distance of 10 metres or thereby.	South
<b>6</b>	<b>Hazelden Park</b>			
6/1		Hazelden Gardens	From the extended south-eastern kerbline of Hazelden Gardens south-eastwards a distance of 20 metres or thereby.	Both
<b>7</b>	<b>Linn Drive</b>			
7/1		1 Linn Drive	From a point 2 metres or thereby east of the extended western feu line of 1 Linn Drive westwards for a distance of 10 metres or thereby.	North
7/2		2 Linn Drive	From a point 2 metres or thereby east of the extended western feu line of 2 Linn Drive westwards for a distance of 10 metres or thereby.	South
7/3		Oakley Drive	From a point 10 metres or thereby southwest of the extended southwestern kerbline of Oakley Drive north-eastwards to a point 10 metres or thereby northeast of the extended north-eastern kerbline of Oakley Drive.	South
<b>8</b>	<b>Moray Drive</b>			
8/1		Stamperland Gardens	From a point 28 metres or thereby west of the extended western kerbline of Stamperland Gardens eastwards to a point 15 metres or thereby south-east of the extended eastern kerbline of Stamperland Gardens.	North
8/2		Stamperland Gardens	From the extended western kerbline of Stamperland Gardens eastwards to a point 18 metres or thereby east of the extended eastern kerbline of Stamperland Gardens.	South
<b>9</b>	<b>Muirend Road</b>			
9/1		Clarkston Road	From the extended eastern feu line of 9 Muirend Road north-westwards to the	South



**SCHEDULE 2**  
**NO WAITING AT ANY**

**Roads In East Renfrewshire**

Ref	Principal Reference Road	Secondary Reference	Lengths of road in East Renfrewshire	Side of road to which restriction applies
			extended eastern kerbline of Braemar Court.	
<b>10</b>	<b>Netherburn Avenue</b>			
10/1		Feu line 5	From a point 9 metres or thereby west of the extended western kerbline of 5 Netherburn Avenue eastwards to a point 2 metres or thereby east of the extended western feu line of 5 Netherburn Avenue.	North
<b>11</b>	<b>Oakley Drive</b>			
11/1		Linn Drive	From the extended southern kerbline of Linn Drive southwards for a distance of 10 metres or thereby.	Both
<b>12</b>	<b>Ormonde Avenue</b>			
12/1		Deanwood Road	From a point 5 metres or thereby north of the extended northern kerbline of Deanwood Road southwards to a point 5 metres or thereby south of the extended southern kerbline of Deanwood Road.	Both
12/2		Parklands Road	From a point 5 metres or thereby northwest of the extended northern kerbline of Parklands Road south-eastwards to a point 5 metres or thereby southeast of the extended southern kerbline of Parklands Road.	Both
12/3		Ormonde Drive	From a point 2 metres or thereby north of the extended southern feu line of 128 Ormonde Avenue southwards for a distance of 10 metres or thereby.	Both
12/4		Ormonde Drive	From the extended northern kerbline of Ormonde Drive northwards for a distance of 10 metres or thereby.	Both
<b>13</b>	<b>Ormonde Court</b>			
13/1		Ormonde Drive	From the extended south-western kerbline of Ormonde Drive south-westwards	Both

**SCHEDULE 2**  
**NO WAITING AT ANY**

**Roads In East Renfrewshire**

<b>Ref</b>	<b>Principal Reference Road</b>	<b>Secondary Reference</b>	<b>Lengths of road in East Renfrewshire</b>	<b>Side of road to which restriction applies</b>
			for a distance of 10 metres or thereby	
<b>14</b>	<b>Ormonde Drive</b>			
14/1		Ormonde Avenue	From a point 10 metres or thereby east of the extended eastern kerbline of Ormonde Avenue north-westwards to appoint 10 metres or thereby west of the extend north-western kerbline of Ormonde Avenue.	North
14/2		Parklands Road	From the extended southern kerbline of Parklands Road southwards a distance of 10 metres or thereby.	Both
<b>15</b>	<b>Parklands Road</b>			
15/1		Ormonde Avenue	From a point 10 metres or thereby northeast of the extended north-eastern kerbline of Ormonde Avenue south-westwards to a point 10 metres or thereby southwest of the extended western kerbline of Ormonde Avenue.	Both
15/2		Ormonde Drive	From the extended north-eastern kerbline of Ormonde Drive north-eastwards for a distance of 10 metres or thereby.	South
15/3		Ormonde Drive	From the extended eastern kerbline of Ormonde Drive north-eastwards for a distance of 10 metres or thereby.	North
<b>16</b>	<b>The Quadrant</b>			
16/1		Stamperland Hill	From the extended eastern kerbline of Stamperland Hill eastwards for a distance of 10 metres or thereby.	Both
<b>17</b>	<b>Randolph Drive</b>			
17/1		Stamperland Hill	From a point 24 metres or thereby west of the extended western kerbline of Stamperland Hill eastwards to a point 14 metres or thereby east of the extended eastern kerbline of Stamperland Hill.	North

**SCHEDULE 2**  
**NO WAITING AT ANY**

**Roads In East Renfrewshire**

Ref	Principal Reference Road	Secondary Reference	Lengths of road in East Renfrewshire	Side of road to which restriction applies
17/2		Stamperland Hill	From a point 11 metres or thereby west of the extended western kerbline of Stamperland Hill eastwards to a point 27 metres or thereby east of the extended eastern kerbline of Stamperland Hill	South
<b>18</b>	<b>Stamperland Avenue</b>			
18/1		Stamperland Hill	From a point 10 metres or thereby north of the extended northern kerbline of Stamperland Hill southwards to a point 10 metres or thereby south of the extended southern kerbline of Stamperland Hill.	West
<b>19</b>	<b>Stamperland Gardens</b>			
19/1		Clarkston Road	From a point 10 metres or thereby southeast of the extended eastern kerbline of Clarkston Road south-eastwards for a distance of 18 metres or thereby.	North
19/2		Stamperland Hill	From a point 14 metres or thereby northwest of the extended western kerbline of Stamperland Hill south-eastwards to a point 10 metres or thereby southeast of the extended eastern kerbline of Stamperland Hill.	North
19/3		Stamperland Hill	From a point 10 metres or thereby northwest the extended western kerbline of Stamperland Hill south-eastwards to a point 11 metres or thereby southeast of the extended eastern kerbline of Stamperland Hill.	South
19/4		Elgin Gardens	From a point 10 metres or thereby north of the extended northern kerbline of Elgin Gardens south-westwards to a point 10 metres or thereby southwest of the extended southern kerbline of Elgin Gardens.	West
19/5		Moray Drive	From the extended northern kerbline of Moray Drive northwards for a distance	Both

**SCHEDULE 2**  
**NO WAITING AT ANY**

**Roads In East Renfrewshire**

Ref	Principal Reference Road	Secondary Reference	Lengths of road in East Renfrewshire	Side of road to which restriction applies
			of 15 metres or thereby.	
<b>20</b>	<b>Stamperland Hill</b>			
20/1		Randolph Drive	From a point 4 metres or thereby north of the extended northern kerbline of Randolph Drive southwards to a point 4 metres or thereby south of the extended southern kerbline of Randolph Drive.	Both
20/2		Stamperland Gardens	From a point 10 metres or thereby north of the extended northern kerbline of Stamperland Gardens southwards to a point 10 metres or thereby south of the extended southern kerbline of Stamperland Gardens.	Both
20/3		The Quadrant	From a point 10 metres or thereby north of the extended northern kerbline of The Quadrant southwards to a point 10 metres or thereby south of the extended southern kerbline of The Quadrant.	East
20/4		Stamperland Avenue	From the extended western kerbline of Stamperland Avenue westwards for a distance of 10 metres or thereby.	Both
<b>21</b>	<b>Strathdon Drive</b>			
21/1		Williamwood Drive	From the extended southern kerbline of Williamwood Drive southwards for a distance of 10 metres or thereby.	Both
<b>22</b>	<b>Strathview Park</b>			
22/1		Clarkston Road	From a point 2 metres or thereby southeast of the extended north-western feu line of 656 Clarkston Road north-westwards for a distance of 10 metres or thereby.	Both

**SCHEDULE 2**  
**NO WAITING AT ANY**

**Roads In East Renfrewshire**

<b>Ref</b>	<b>Principal Reference Road</b>	<b>Secondary Reference</b>	<b>Lengths of road in East Renfrewshire</b>	<b>Side of road to which restriction applies</b>
<b>23</b>	<b>Williamwood Drive</b>			
23/1		Clarkston Road	From a point 2 metres or thereby east of the extended western feu line of 608 Clarkston Road westwards for a distance of 10 metres or thereby.	North
23/2		Williamwood Park	From a point 10 metres or thereby eastwards of the extended eastern kerbline of Williamwood Park westwards to a point 10 metres or thereby west of the extended western kerbline of Williamwood Park.	North
23/3		Williamwood Park	From a point 2 metres or thereby east of the extended western feu line of 2 Williamwood Park westwards for a distance of 10 metres or thereby.	North
23/4		Williamwood Park West	From a point 12 metres or thereby east of the extended eastern kerbline of Williamwood Park West westwards to a point 10 metres or thereby west of the extended western kerbline of Williamwood Park West.	North
23/5		Williamwood Park West	From a point 2 metres or thereby east of the extended western feu line of 1 Williamwood Park West westwards for a distance of 10 metres or thereby.	North
23/6		Strathdon Drive	From a point 13 metres or thereby east of the extended eastern kerbline of Strathdon Drive westwards to a point 10 metres or thereby west of the extended western kerbline of Strathdon Drive.	South
<b>24</b>	<b>Williamwood Park</b>			
24/1		Williamwood Drive	From the extended northern kerbline of Williamwood Drive northwards for a distance of 10 metres or thereby.	Both

**SCHEDULE 2**  
**NO WAITING AT ANY**

**Roads In East Renfrewshire**

<b>Ref</b>	<b>Principal Reference Road</b>	<b>Secondary Reference</b>	<b>Lengths of road in East Renfrewshire</b>	<b>Side of road to which restriction applies</b>
<b>25</b>	<b>Williamwood Park West</b>			
25/1		Williamwood Drive	From the extended northern kerbline of Williamwood Drive northwards for a distance of 10 metres or thereby.	Both
<b>26</b>	<b>Windlaw Gardens</b>			
26/1		Clarkston Road	From the extended western feu line of 400 Clarkston Road eastwards for a distance of 17 metres or thereby.	South
26/2		Feu Line between 18 & 20	From the extended feu line between 18 and 20 Windlaw Gardens westwards and then southwards to the extended feu line between 5 and 7 Windlaw Gardens.	South and East
26/3		Feu line 22	From a point 4 metres or thereby northeast of the extended western feu line of 22 Windlaw Gardens south-westwards and then southwards to a point 16 metres or thereby north of the extended northern kerbline of Deanwood Avenue.	North
<b>27</b>	<b>Windlaw Park Gardens</b>			
27/1		Windlaw Gardens	From the extended northern kerbline of Windlaw Gardens north-westwards and then westwards for a distance of 55 metres or thereby.	Both



**SCHEDULE 3**  
**NO WAITING AT ANY TIME AND NO LOADING 8:00 – 9:30AM & 4:30-6:00PM MONDAY TO SATURDAY**

Roads In East Renfrewshire			Lengths of road in East Renfrewshire	Side of road to which restriction applies
Ref	Principal Reference Road	Secondary Reference		
<b>1</b>	<b>Clarkston Road</b>			
1/1		Brenfield Road	From a point 10 metres or thereby south of the extended southern kerbline of Brenfield Road southwards to a point 12 metres or thereby northwards of the extended northern kerbline of Corrie Grove.	East
1/1		Bute Gardens	From the extended northern kerbline of Bute Gardens northwards to the extended feu line between 400 and 402 Clarkston Road.	West
1/2		Bute Gardens	From a point 11 metres or thereby north of the extended northern kerbline of Bute Gardens northwards to the extended feu line between 545 and 547 Clarkston Road.	East

**SCHEDULE 4**  
**WAITING LIMITED TO 60 MINUTES WITH NO RETURN WITHIN 60 MINUTES 9AM-5PM MONDAY TO FRIDAY**

Ref	Roads In East Renfrewshire		Lengths of road in East Renfrewshire	Side of road to which restriction applies
	Principal Reference Road	Secondary Reference		
<b>1</b>	<b>Clarkston Road</b>			
1/1		Linn Park Avenue	From a point 10 metres or thereby southwest of the extended southern kerbline of Linnpark Avenue south-westwards to the extended southern feu line of 689 Clarkston Road.	East
1/2		Netherburn Avenue	From a point 10 metres or thereby southwest of the extended southern kerbline of Netherburn Avenue south-westwards a distance of 35 metres or thereby.	East
1/3		Ormonde Drive	From a point 12 metres or thereby southwest of the extended southern kerbline of Ormonde Drive south-westwards a distance of 21 metres or thereby.	West
1/4	(Stamperland Crescent)	Stamperland Gardens	From a point 10 metres or thereby south of the extended southern kerbline of Stamperland Gardens south-westwards to the extended northern feu line of 38 Clarkston Road.	East
<b>2</b>	<b>Stamperland Gardens</b>			
2/1		Clarkston Road	From a point 28 metres or thereby southeast of the extended eastern kerbline of Clarkston Road south-eastwards a distance of 26 metres or thereby.	North
2/2		Clarkston Road	From a point 10 metres or thereby southeast of the extended eastern kerbline of Clarkston Road south-eastwards a distance of 31 metres or thereby.	South





**SCHEDULE 5**  
**NO WAITING 8AM-6PM MONDAY TO FRIDAY**

	<b>Roads In East Renfrewshire</b>			
<b>Ref</b>	<b>Principal</b>	<b>Secondary</b>	<b>Lengths of road in East Renfrewshire</b>	<b>Side of road to</b>
	<b>Reference Road</b>	<b>Reference</b>		<b>which</b>
				<b>restriction</b>
				<b>applies</b>

<b>1</b>	<b>Moray Drive</b>			
1/1		Stamperland Drive	From a point 20 metres or thereby southeast of the extended southern kerblineline of Stamperland Drive south-eastwards to a point 28 metres or thereby west of the extended western kerblineline of Stamperland Gardens.	Northeast
1/2		Stamperland Gardens	From a point 15 metres or thereby south-east of the extended eastern kerblineline of Stamperland Gardens eastwards to the extended feu line between 82 and 84 Moray Drive.	Both



**SCHEDULE 6**  
**ORDERS TO BE REVOKED**

Ref No.

- 1 The East Renfrewshire Council (Netherlee)(Waiting and Loading)(Consolidation) Order 2013
- 2 The Corporation of Glasgow (Muirend Road) (Traffic Regulation) Order 1974 is varied to the following extent: The Order is revoked to the extent only of the length of road located within East Renfrewshire Council.





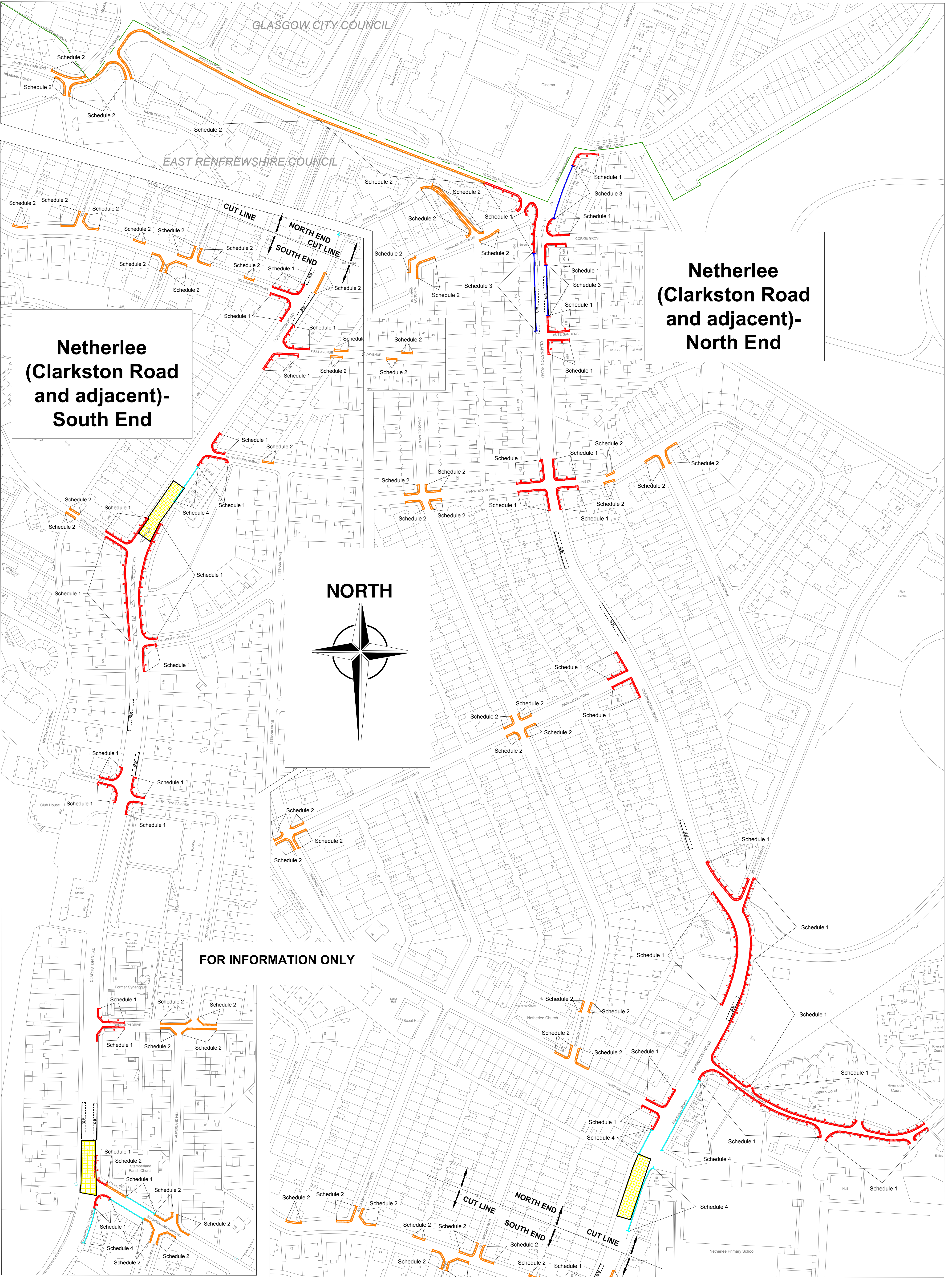

**Netherlee  
(Clarkston Road  
and adjacent)-  
South End**

**Netherlee  
(Clarkston Road  
and adjacent)-  
North End**



**FOR INFORMATION ONLY**

**Drawing Info. NETHERLEE & STAMPERLAND ON-STREET WAITING AND LOADING RESTRICTIONS:**

- Schedule 1- No Waiting and No Loading at Any Time
- Schedule 2- No Waiting at Any Time
- Schedule 3- No Waiting at Any Time and No Loading 8-9:30am and 4:30-6pm Monday-Saturday
- Schedule 4- Waiting Limited to 60 Minutes with no return within 60 minutes 9am-5pm Monday-Friday
- Schedule 5- No Waiting 8am-6pm Monday to Friday
- Pedestrian Crossing (Indicative location only - does not form part of the Order)
- Bus Stop (Indicative location only - does not form part of the Order)

EAST RENFREWSHIRE COUNCIL - ENVIRONMENT DEPARTMENT  
Roads Service - 2 Spiersbridge Way, Spiersbridge Business Park, Thornliebank, G46 8NG  
Head of Environmental Services & Roads - Andrew Corry

<b>Drawing Title</b>	The East Renfrewshire Council (Netherlee & Stammerland) (On-Street) (Waiting and Loading) Order 2016	<b>Dwg By</b>	NM	<b>Date</b>	Sept 2016
<b>Dwg No.</b>	Page 1 of 2	<b>Checked By</b>	SCALE	<b>Scale</b>	NOT TO SCALE
<b>File Ref.</b>	ER-58-40-321	<b>Rev.</b>	12	<b>PD</b>	



Reproduced from the Ordnance Survey Mapping with the permission of Her Majesty's Stationary Office (C) Crown Copyright. Unauthorised reproduction infringes Crown Copyright and may lead to prosecution or civil proceedings. ERC Licence No. (c) Crown Copyright. 100023382 2016.



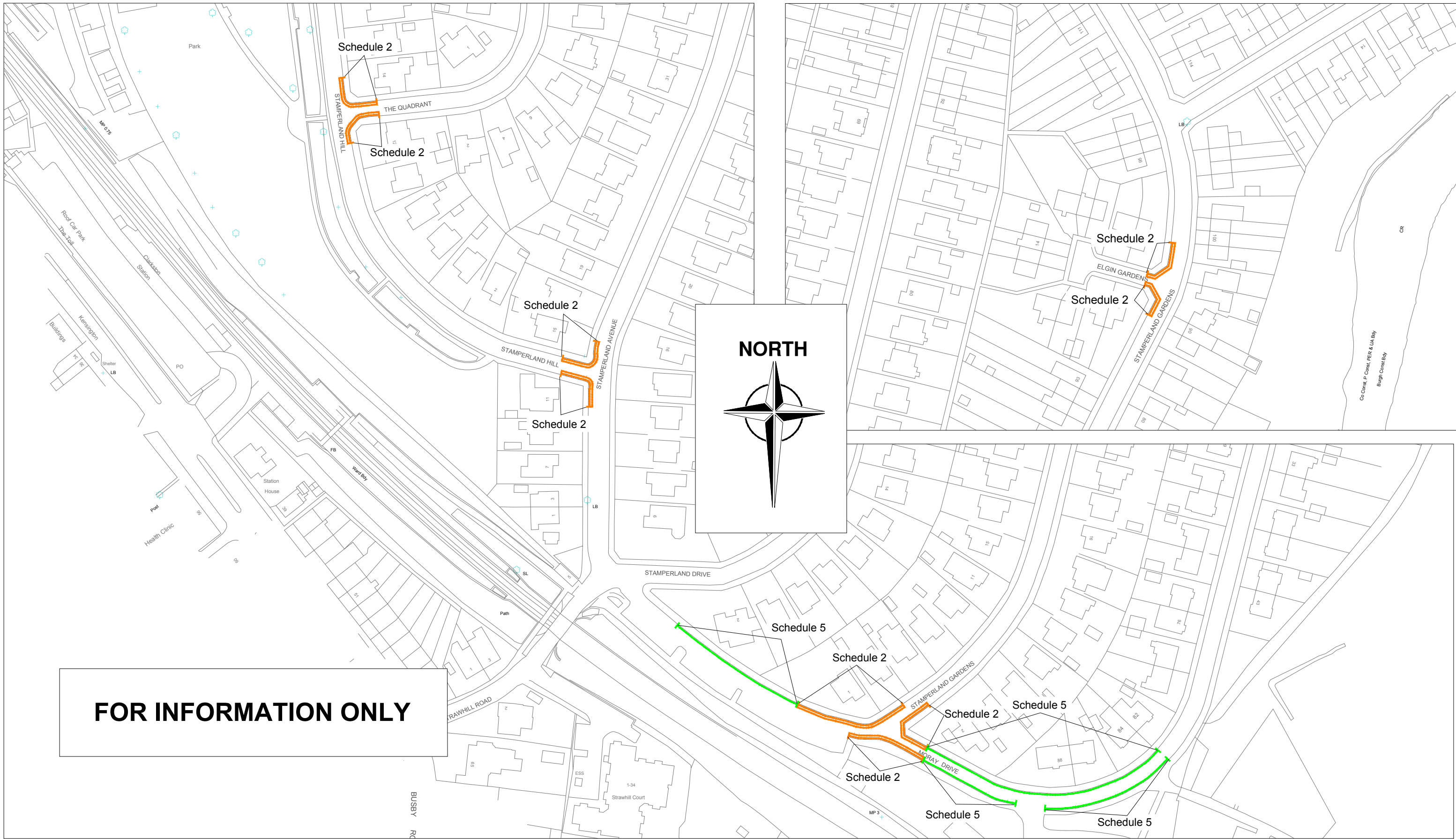

**FOR INFORMATION ONLY**

**Drawing Info.**

**NETHERLEE & STAMPERLAND- ON-STREET WAITING AND LOADING RESTRICTIONS:**

- Schedule 2- No Waiting at Any Time
- Schedule 5 - No Waiting 8am to 6pm Monday to Friday

**EAST RENFREWSHIRE COUNCIL - ENVIRONMENT DEPARTMENT**  
 Roads Service - 2 Spiersbridge Way, Spiersbridge Business Park, Thornliebank, G46 8NG  
 Head of Service - A. Corry

**Drawing Title** The East Renfrewshire Council  
 (Netherlee & Stamperland)  
 (On-Street) (Waiting and Loading) Order 2016

**Dwg No.** Page 2 of 2

**File Ref.** ER-58-40-321

**Rev.** 12

**Dwg By** NM

**Date** Sept 2016

**Checked By** PD

**Scale** Not to scale

Reproduced from the Ordnance Survey Mapping with the permission of Her Majesty's Stationary Office (C) Crown Copyright. Unauthorised reproduction infringes Crown Copyright and may lead to prosecution or civil proceedings. ERC Licence No. (c) Crown Copyright. 100023382 2016.

